

TYPICAL [2ND TO 4TH] FIRST FLOOR PLAN

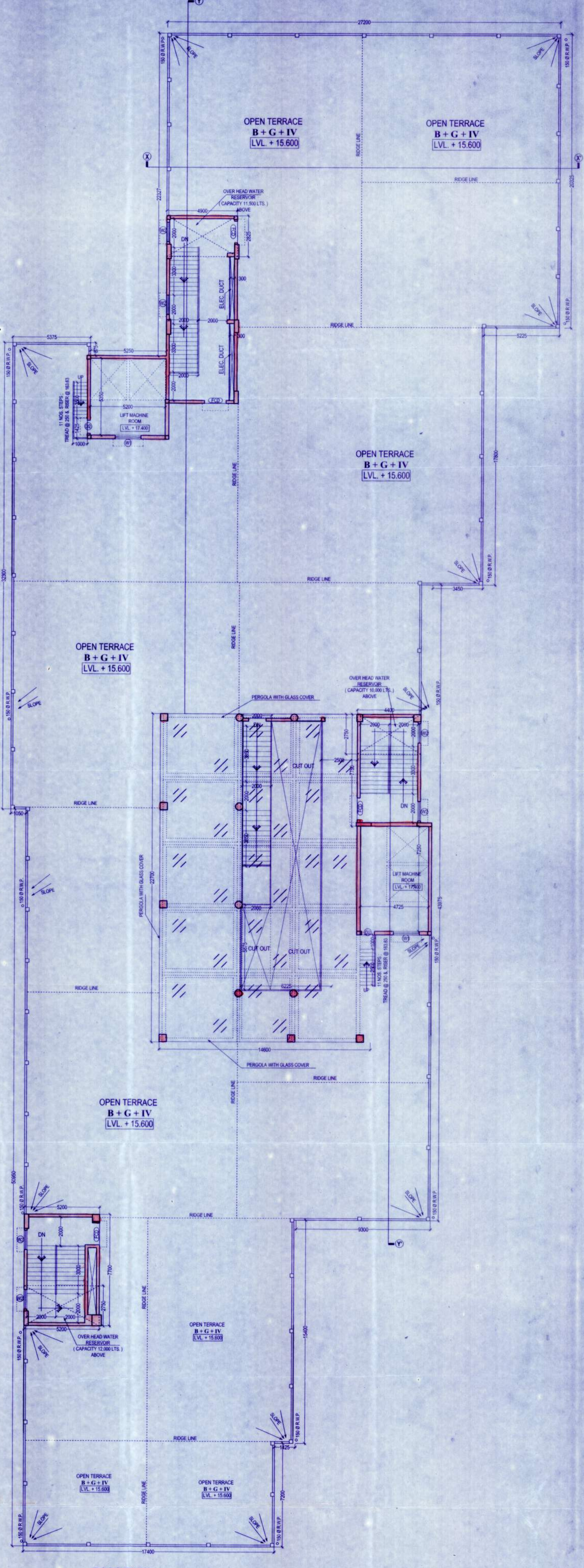

ROOF PLAN

DECLARATION OF ENGINEER / ARCHITECT.
I / WE DO HERE BY DECLARE WITH FULL RESPONSIBILITY THAT I / WE SHALL ENGAGE L.B.A & E.S.L. DURING CONSTRUCTION I / WE SHALL FOLLOW THE INSTRUCTIONS OF L.B.A & E.S.L. DURING CONSTRUCTION OF THE BUILDING (AS PER B.S PLAN) GRAM PANCHAYET AUTHORITY WILL NOT BE RESPONSIBLE FOR STRUCTURAL STABILITY OF THE BUILDING & ADJOINING. IF ANY SUBMITTED DOCUMENTS ARE FOUND TO BE FAKE, THE GRAM PANCHAYET AUTHORITY MAY REVOKE THE SANCTION PLAN. THE CONSTRUCTION OF WATER RESERVOIR WILL BE UNDER TAKEN UNDER THE GUIDANCE OF E.S.E / L.B.A BEFORE STARTING OF BUILDING FOUNDATION WORK.

ANGURANISHAN PVT. LTD.
DIRECTOR
SIGNATURE OF OWNER / AUTHORITY

DECLARATION OF ENGINEER / ARCHITECT.
I CERTIFY THAT ALL THE ARCHITECTURAL DRAWINGS OF THE PROJECT AT R.S. DAG NO. 637, 656, 657, 658, 659, 660, 661 / 2107, 661 & 662, L.R. DAG NO. 600, 620, 621, 622, 623, 624, 625, 626 & 627, R.S. KHATIAN NO. 1203, 1223, 1398, 1394, 1393 & 336 L.R. KHATIAN NO. 1748, MOUZA - BANKRA, J.L. NO. 55, TOUZI NO. 3989, R.S. NO. 1954, UNDER BANKRA - 1 GRAM PANCHAYET, P.S. DOMJUR, DISTRICT HOWRAH PIN : 711 403, HAVE BEEN PREPARED BY ME COMPLYING WITH THE PROVISIONS OF HOWRAH ZILLA PARISHAD BYE LAW 2005, AND THE NATIONAL BUILDING CODE OF INDIA, AS AMENDED FROM TIME TO TIME. NO SUCH WRONG AND INCORRECT INFORMATION HAS BEEN FURNISHED BY ME INCLUDING AREA CALCULATION CHARTS IN THIS DRAWING AND NO VIOLATION OF THE PROVISIONS OF THESE RULES WILL BE FOUND IN ANY OF THE DRAWINGS AND DOCUMENTS, SUBMITTED TO THE SANCTIONING AUTHORITY FOR OBTAINING SANCTIONS.

RAM CHANDRA KANRAR
L.B.S. (127) No. 30 CLASS-1
Dhanu, Sehgara, C.P. Colony,
Durgam, Howrah,
Mob. No. 9830047045
ANUPAM GHOSH
Registered Architect
Reg. No. CA200502658
SIGNATURE OF ARCHITECT

CERTIFICATE OF STRUCTURAL ENGINEER
CERTIFY THAT THE STRUCTURAL DRAWING AND DESIGN OF BOTH THE FOUNDATION AND SUPERSTRUCTURE OF THE BUILDING / BUILDINGS HAS BEEN MADE CONSIDERING THE SOIL TEST REPORT (AS PER THESE RULE AND REGULATIONS MADE UNDER THE ACT) AND ALSO CONSIDERING ALL POSSIBLE LOADS, SEISMIC LOAD AND THE MOMENTS GENERATED BY THE PROPOSED STRUCTURE AS PER CURRENT CODES, THE BUREAU OF INDIAN STANDARD AND NATIONAL BUILDING CODE OF INDIA AND CERTIFY THAT IT IS SAFE AND STABLE IN ALL RESPECT UP TO G+V STORIES AND THESE PROVISIONS SHALL BE ADHERED TO DURING THE CONSTRUCTION.
SANJIV J. PAREKH
REG. STRUCT. ENGR. (HON'BLE ENGR.)
R.C.E. No. 116-EP-0720240
E.S.E. No. 116-EP-0720240
SIGNATURE OF STRUCTURAL ENGINEER

SPACE FOR OFFICE USE ONLY :-

DOOR & WINDOW SCHEDULE :-

MARKED	TYPE	SILL HEIGHT FROM FLOOR	LINTEL HEIGHT FROM FL.	SIZE	MARKED	TYPE	SILL HEIGHT FROM FLOOR	LINTEL HEIGHT FROM FL.	SIZE
D1	SOLID FLUSH	2100	2000 X 2100	W1	GLAZED	600	2100	1800 X 1500	
D2	SOLID FLUSH	2100	600 X 2100	W2	GLAZED	600	2100	1350 X 1500	
RS	METAL SHUTTER	2100	-----	W3	GLAZED	1350	2100	600 X 750	
FCD	-----	-----	-----	-----	-----	-----	-----	-----	

SPECIFICATION OF CONSTRUCTION :-
1) 250 THK. 1ST CLASS CEMENT BRICK WORK FOR EXTERNAL WALL IN SUPER STRUCTURE IN 1 : 6
2) 125 THK. 1ST CLASS CEMENT BRICK WORK FOR INTERNAL WALL IN 1 : 4
3) LEAN CONCRETE, 1 : 3 : 6 WITH 18 MM DOWN GRADED STONE CHIPS (M-15)
4) R.C.C. 1 : 2 : 4 FOR ROOF SLAB, BEAM, LINTEL, CHAJJA ETC.
5) CEMENT SAND PLASTER 18 MM. ON OUTSIDE & 12 MM. ON INSIDE WALL IN 1 : 6 & CEILING & CHAJJA IN 1 : 4.
6) D.P.C. SHALL BE 50MM THICK IN 1 : 1.5 : 3 TONE WITH WATER PROOFING ADMIXTURE
7) 25 MM. THK. I.P.S. FLOORING WITH HEAT CEMENT FINISH AT TOP
8) 75 MM. THK. SINGLE BRICK FLAT SOLING ON FOUNDATION
9) + 600 LVL. TO THE FINISHED GROUND FLOOR LVL. & 300 LVL. PLINTH AT GROUND FLOOR
10) TREAD WIDTH 250 EACH & 23 EQ. NOS. RISER HEIGHT IS 130.435 MM. FOR
11) FLOOR TO SLAB HEIGHT SHALL BE 3000 FOR GROUND FLOOR & 2900 MM THICKNESS OF THE SLAB SHALL BE 100 MM.
MATERIALS :-
STEEL MUST BE CONFIRMED WITH IS 1786
GRADE OF CONCRETE :- M 20 (C : S : ST :: 1 : 1.5 : 3) & GRADE OF STEEL :- Fe 550
CEMENT :- ORDINARY PORTLAND, SAND - MEDIUM COARSE
STONE CHIPS - 20 MM. DOWN GRADED
OTHER DETAILS AS PER ARCHITECT OR ENGINEER - IN - CHARGE

PROJECT :-
PROPOSED BASEMENT + GROUND + FOUR STORIED [15.600 METER HEIGHT] COMMERCIAL BUILDING AT R.S. DAG NO. 637, 656, 657, 658, 659, 660, 661 / 2107, 661 & 662, L.R. DAG NO. 600, 620, 621, 622, 623, 624, 625, 626 & 627, R.S. KHATIAN NO. 1203, 1223, 1398, 1394, 1393 & 336, L.R. KHATIAN NO. 1748, MOUZA - BANKRA, J.L. NO. 55, TOUZI NO. 3989, R.S. NO. 1954, UNDER BANKRA - 1 GRAM PANCHAYET, P.S. DOMJUR, DISTRICT HOWRAH, WEST BENGAL, PIN : 711 403.

TITLE :-
TYPICAL 2ND TO 4TH FLOOR & ROOF PLAN

DRAWING SHEET NO. 03

DEALT : A. BARMAN & S.KHANDA

DATE : 31.08.2019

ALL DIMENSIONS ARE IN M.M. (UNLESS OTHERWISE MENTIONED)

SCALE 1 : 100
(UNLESS OTHERWISE MENTIONED)

Consulting Architect : MAHESWARI & ASSOCIATES
37A, BAKER ROAD, 2ND FLOOR
ALIPUR, KOLKATA - 700 027
www.architect.in

Structural Engineers : S.P.A CONSULTANTS
54, 55A, 56A, 57TH ROAD
CHAITRA - 700008
TEL. NO. 2485-5442/5443/2475-7614/7616 FAX
E-MAIL: s.p.a.consultants@gmail.com

Project Architects : COLLAGE ARCHITECTS
1488, RAJDANGA MAIN ROAD, (OPPOSITE PURBA ABASAN, DF BLOCK), KOLKATA 700 107, INDIA
PHONE NO. (033) 4802 6909, E-MAIL: collage.architects.info@gmail.com

THIS DRAWING IS A PROPERTY OF COLLAGE. ANY MODIFICATION, CHANGES, DEVIATIONS IS NOT PERMISSIBLE WITHOUT PRIOR INTIMATION OF THE ARCHITECT, TO THE CONTRARY THIS WILL BE TREATED AS ILLEGAL ACT.